

# ***Hitank***<sup>®</sup>

Water Storage Tanks

DEALERS PRICELIST-2026



# TABLE OF CONTENT

	Page No.
<b>01</b>	Overhead Water Tanks - Outdoor Usage <b>01-02</b>
<b>02</b>	Containers & Industrial Products - Indoor Usage <b>03-04</b>
<b>03</b>	Dustbins <b>05-06</b>
<b>04</b>	FRP Chamber Covers <b>07-08</b>
<b>05</b>	Kitchen Quartz Sinks <b>09-11</b>
<b>06</b>	Garden Hose Pipes <b>12-13</b>
<b>07</b>	Bathwares
	▪ One Piece Closets <b>14-18</b>
	▪ Wall Hung Closets <b>19</b>
	▪ EWC & Indian Closets <b>20</b>
	▪ Pedestal Basins <b>21</b>
	▪ Table Top Basins <b>22-26</b>
	▪ Integrated Wall Hung Basins <b>27</b>
	▪ Wall Hung Basins <b>28-32</b>
	▪ One Piece Basins <b>33</b>
<b>08</b>	Health Faucets <b>34-35</b>
<b>09</b>	Taps & Fittings
	▪ Charcoal Series <b>36-38</b>
	▪ Eco Series <b>39-40</b>
	▪ Prime Series <b>41</b>
	▪ Classic Series <b>41</b>
<b>10</b>	Floor Drainers <b>42-44</b>
<b>11</b>	Bath Accessories <b>45-46</b>

# OVERHEAD WATER TANKS

## - OUTDOOR USAGE

### Hitank® 5 LAYER - ANTIMICROBIAL

LAYER OPTION: 5 Layer Tanks

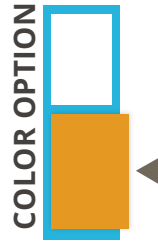

#### DIMENSION IN INCHES

SIZE	HEIGHT	DIAMETER	DIA (MH)	RATE/LTR
				5 LAYERS YELLOW/WHITE
500	43.0	34.0	14.5	₹21.20
750	48.5	38.5	14.5	₹20.50
1000	55.0	42.5	14.5	₹20.50
1500	61.0	48.5	14.5	₹20.50
2000	66.5	53.5	14.5	₹20.50

### Hitank® PEARL - ANTIMICROBIAL

LAYER OPTION: 4 Layer Tanks



#### DIMENSION IN INCHES

SIZE	HEIGHT	DIAMETER	DIA (MH)	RATE/LTR
				4 LAYERS WHITE
500	39.0	34.5	14.5	₹20.15
750	44.0	39.5	14.5	₹19.45
1000	48.0	42.0	14.5	₹19.45
1500	56.0	49.0	14.5	₹19.45
2000	62.0	55.0	14.5	₹19.45

### Hitank® SSWACHH

LAYER OPTION: 2,3 & 4 Layer Tanks

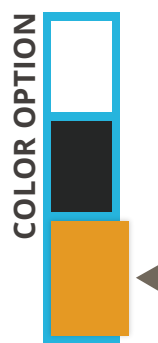

#### DIMENSION IN INCHES

SIZE	HEIGHT	DIAMETER	DIA (MH)	RATE/LTR			
				2 LAYERS BLACK	3 LAYERS BLACK	3 LAYERS YELLOW/WHITE	4 LAYERS WHITE
300	26.5	32.0	14.5	NA	₹16.05	₹16.75	₹19.20
500	39.5	34.0	14.5	NA	₹16.05	₹16.75	₹19.20
750	44.0	40.0	14.5	NA	₹15.35	₹16.05	₹18.50
1000	48.0	43.0	14.5	NA	₹15.35	₹16.05	₹18.50
1500	56.0	51.0	14.5	NA	₹15.35	₹16.05	₹18.50
2000	62.0	55.0	14.5	NA	₹15.35	₹16.05	₹18.50
3000	71.5	61.5	15.8	₹14.20	₹15.35	₹16.05	NA
5000	82.0	74.5	15.8	₹14.20	₹15.35	₹16.05	NA

Image only for reference purpose\*

GST & Transportation extra as applicable\*

Dimensions are approximate, not for weights & measurement\*

# Hitank® CLASSIC

LAYER OPTION: 2 & 3 Layer Tanks

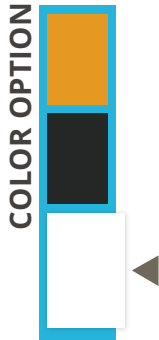

DIMENSION IN INCHES						
SIZE	HEIGHT	DIAMETER	DIA (MH)	RATE/LTR		
				2 LAYERS BLACK	3 LAYERS BLACK	3 LAYERS YELLOW/WHITE
10000	104.5	89.2	18.1	₹21.65	₹22.8	₹23.95
15000	141.0	100.5	18.1	₹35.60	NA	NA
20000	180.1	100.5	18.1	₹35.60	NA	NA

# POLYTANK

LAYER OPTION: 3 Layer Tanks

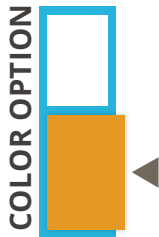

DIMENSION IN INCHES					
SIZE	HEIGHT	DIAMETER	DIA (MH)	RATE/LTR	
				3 LAYERS YELLOW	3 LAYERS WHITE
500	37.0	34.0	14.5	₹14.55	₹14.80
750	43.0	40.0	14.5	₹13.85	₹14.10
1000	48.0	42.0	14.5	₹13.85	₹14.10
1500	55.0	50.0	14.5	₹13.85	₹14.10
2000	60.0	55.0	14.5	₹13.85	₹14.10

# CONTAINERS & INDUSTRIAL PRODUCTS

## - INDOOR USAGE

### Hitank® LOFT TANK



#### DIMENSION IN INCHES

SIZES	LENGTH	BREADTH	HEIGHT	DIA (MH)	RATE/PC
					SINGLE LAYER NATURAL COLOUR
150	28.5	28.5	15.5	14.0	₹3,450
270	41.5	26.0	18.0	14.0	₹6,210
375	51.0	33.0	15.5	14.0	₹8,625
500	59.5	35.5	16.0	14.0	₹11,500
1000	75.6	48.7	21.3	14.0	₹23,000

### CHEMICAL STORAGE TANKS

LAYERS OPTION: 3 Layer Tanks



COLOR OPTION



#### DIMENSION IN INCHES

SIZE	HEIGHT	DIAMETER	DIA (MH)	RATE/PC
				3 LAYERS BLACK / WHITE
500	39.5	34.0	14.5	₹10,125
750	44.0	40.0	14.5	₹14,625
1000	48.0	43.0	14.5	₹19,500
1500	56.0	51.0	14.5	₹29,250
2000	62.0	55.0	14.5	₹39,000
3000	71.5	61.5	15.8	₹58,500
5000	82.0	74.5	15.8	₹97,500

### HOUSEHOLD DRUMS



#### DIMENSION IN INCHES

SIZE	HEIGHT	DIAMETER	DIA (MH)	RATE/PC
				SINGLE LAYER NATURAL COLOUR
100	27.8	17.6	11.8	₹2,700/-
150	34.3	19.7	11.8	₹4,125/-
200	38.0	21.3	11.8	₹5,550/-

Image only for reference purpose\*

GST & Transportation extra as applicable\*

Dimensions are approximate, not for weights & measurement\*

## INDUSTRIAL CONTAINERS



### DIMENSION IN INCHES

SIZE	HEIGHT	DIAMETER	RATE/PC
			SINGLE LAYER NATURAL COLOUR
60	19.5	16.4	₹2,430/-
100	29.9	17.5	₹3,240/-
220	29.7	26.2	₹6,075/-
500	42.9	31.9	₹12,150/-
1000	60.4	38.8	₹25,380/-
2000	57.5	57.1	₹47,250/-

## PROCESSING TROLLEY CRATES

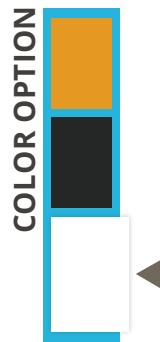

### DIMENSION IN INCHES

SIZE	TOP LENGTH	TOP WIDTH	HEIGHT	RATE/PC
100	23.2	23.2	23.0	₹3,510/-
480	40.2	34.3	30.3	₹10,395/-
650	56.3	38.6	30.9	₹15,390/-
1200	65.0	43.3	30.5	₹22,194/-
1450	75.8	45.7	30.5	₹29,349/-
2100	108.1	48.2	32.7	₹42,660/-

## DOFFING CRATES

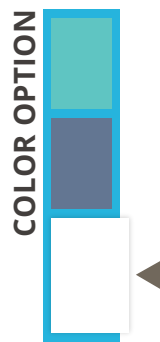

### DIMENSION IN INCHES

CAPACITY	LENGTH	WIDTH	HEIGHT	RATE/PC
20	15.6	11.6	8.9	₹1,350/-
40	15.7	11.6	12.8	₹2,160/-
50	20.5	14.2	12.8	₹2,673/-
60	23.6	15.6	11.3	₹3,213/-
70	23.6	15.6	12.9	₹3,510/-

Image only for reference purpose\*

GST & Transportation extra as applicable\*

Dimensions are approximate, not for weights & measurement\*

# DUSTBINS

## AW BIG



### DIMENSION IN INCHES

SIZE	LENGTH	WIDTH	HEIGHT	RATE/PC
660	54.0	31.0	48.0	₹ 47,160/-
1100	54.0	41.0	51.0	₹ 58,850/-

## AW



### DIMENSION IN INCHES

SIZE	LENGTH	WIDTH	HEIGHT	RATE/PC
50	17.0	17.0	25.6	₹ 2,125/-
120	22.0	19.0	38.0	₹ 4,590/-
240	29.0	23.0	43.0	₹ 7,020/-
360	34.0	28.0	44.5	₹ 18,050/-

## SW



### DIMENSION IN INCHES

SIZE	HEIGHT	TOP DIA	BOTTOM DIA	RATE/PC
50	25.0	20.5	6.3	₹ 1,215/-
75	29.6	20.5	6.3	₹ 1,380/-

Image only for reference purpose\*

Dimensions are approximate, not for weights & measurement\*

Transportation extra as applicable\*

**FS**

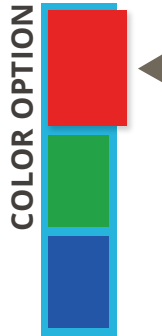

**DIMENSION IN INCHES**

SIZE	LENGTH	WIDTH	HEIGHT	RATE/PC
<b>FS INJECTION MOULDING</b>				
60 INJ	11.7	11.7	33.8	₹ 1,945/-
80 INJ	12.4	12.4	34.4	₹ 2,380/-

**LD**

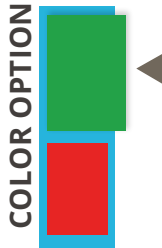

Mrp  
₹ 2,000/-

**35 LTRS WITH LID**

**QSB-10**

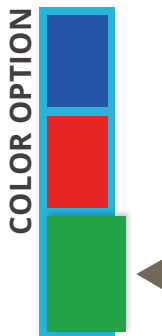

PP  
Mrp  
₹ 140/-

**10 LTRS**

Image only for reference purpose\*

Dimensions are approximate, not for weights & measurement\*

Transportation extra as applicable\*

# FRP CHAMBER COVERS

## FRP MANHOLE COVER (Square) - 5 Tons



### COLOR OPTION



### DIMENSION & RATE/PC

FRAME SIZE		CLEAR OPENING		UNIT PRICE	WEIGHT (APPROX)
INCHES	MM	INCHES	MM	(INCL. OF GST)	KG/PC
10*10	250*250	8*8	200*200	₹ 900/-	2.10
12*12	300*300	10*10	260*260	₹ 1,075/-	3.60
15*15	380*380	13*13	330*330	₹ 1,350/-	4.80
18*18	450*450	14*14	355*355	₹ 1,975/-	7.50
21*21	535*535	18*18	450*450	₹ 2,775/-	11.00
24*24	600*600	20*20	510*510	₹ 3,300/-	14.80
26*26	660*660	22*22	560*560	₹ 4,325/-	19.70
28*28	710*710	24*24	600*600	₹ 6,200/-	26.00
30*30	760*760	25*25	635*635	₹ 7,425/-	32.00
36*36	900*900	30*30	780*780	₹ 14,225/-	54.00
42*42 Manual	1060*1060	36*36	915*915	₹ 30,000/-	86.00

## FRP MANHOLE COVER (Rectangular) - 5 Tons



### COLOR OPTION



### DIMENSION & RATE/PC

FRAME SIZE		CLEAR OPENING		UNIT PRICE	WEIGHT (APPROX)
INCHES	MM	INCHES	MM	(INCL. OF GST)	KG/PC
12*18	300*450	10*16	260*410	₹ 1,475/-	4.75
12*24	300*600	10*20	230*530	₹ 2,075/-	6.70
18*24	450*600	14*20	355*510	₹ 2,700/-	10.70
18*36	450*900	13*31	330*780	₹ 6,675/-	24.00
24*30	600*760	19*25	492*642	₹ 6,675/-	22.50
24*36	600*900	19*31	470*770	₹ 7,800/-	29.00

Image only for reference purpose\*

Dimensions are approximate, not for weights & measurement\*

Transportation extra as applicable\*

# FRP MANHOLE COVER- 5 Tons - With Lock & Hinges



DIMENSION & RATE/PC					
FRAME SIZE		CLEAR OPENING		UNIT PRICE	WEIGHT (APPROX)
INCHES	MM	INCHES	MM	(INCL. OF GST)	KG/PC
18*18	450*450	14*14	350*350	₹ 2,650/-	7.50
24*24	600*600	20*20	510*510	₹ 4,225/-	14.80
26*26	650*650	22*22	560*560	₹ 5,250/-	18.00
28*28	710*710	24*24	600*600	₹ 7,200/-	26.00
30*30	750*750	25*25	635*635	₹ 8,200/-	32.00

COLOR OPTION

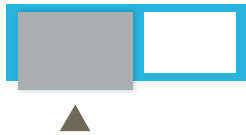

# FRP MANHOLE COVER- Walkway



DIMENSION & RATE/PC					
FRAME SIZE		CLEAR OPENING		UNIT PRICE	WEIGHT (APPROX)
INCHES	MM	INCHES	MM	(INCL. OF GST)	KG/PC
24*24	600*600	20*20	510*510	₹ 2,775/-	13.50

COLOR OPTION

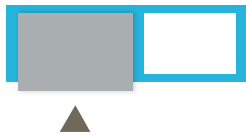

Image only for reference purpose\*

Dimensions are approximate, not for weights & measurement\*

Transportation extra as applicable\*

# QUARTZ SINKS

## HI-1618S - SINGLE BOWL



**SIZE:** 16\*18\*9  
**BOWL TYPE:** Single  
**COUPLING SHAPE:** Square  
**WEIGHT ( Approx):** 8.000 KG

Mrp  
 ₹ 4,350/-

## HI-2118S - SINGLE BOWL



**SIZE:** 21\*18\*9  
**BOWL TYPE:** Single  
**COUPLING SHAPE:** Square  
**WEIGHT ( Approx):** 10.500 KG

Mrp  
 ₹ 4,650/-

## HI-2418S - SINGLE BOWL



**SIZE:** 24\*18\*9  
**BOWL TYPE:** Single  
**COUPLING SHAPE:** Square  
**WEIGHT ( Approx):** 12.000 KG

Mrp  
 ₹ 4,725/-

## HI-2418 DIAMOND - SINGLE BOWL



**SIZE:** 24\*18\*9  
**BOWL TYPE:** Single  
**COUPLING SHAPE:** Square  
**WEIGHT ( Approx):** 12.000 KG

Mrp  
 ₹ 5,400/-

**HI-2420S - SINGLE BOWL**

**SIZE:** 24\*20\*9  
**BOWL TYPE:** Single  
**COUPLING SHAPE:** Round  
**WEIGHT ( Approx):** 11.500 KG

Mrp  
**₹ 7,200/-**

**HI- 3020S - SINGLE BOWL**

**SIZE:** 30\*20\*9  
**BOWL TYPE:** Single  
**COUPLING SHAPE:** Round  
**WEIGHT ( Approx):** 12.500 KG

Mrp  
**₹ 9,400/-**

**HI-3119S - SINGLE BOWL**

**SIZE:** 31\*19\*10  
**BOWL TYPE:** Single  
**COUPLING SHAPE:** Round  
**WEIGHT ( Approx):** 14.000 KG

Mrp  
**₹ 9,400/-**

**HI-3118DB - DOUBLE BOWL**

**SIZE:** 31\*18\*9  
**BOWL TYPE:** Double  
**COUPLING SHAPE:** Round  
**WEIGHT ( Approx):** 16.000 KG

Mrp  
**₹ 12,600/-**

## HI-3618SBD - DRAIN BOARD



**SIZE:** 36\*18\*9  
**BOWL TYPE:** Single  
**COUPLING SHAPE:** Square  
**WEIGHT ( Approx):** 15.600 KG

Mrp  
**₹ 10,275/-**

## HI- 3718DB - DOUBLE BOWL



**SIZE:** 37\*18\*9  
**BOWL TYPE:** Single  
**COUPLING SHAPE:** Double  
**WEIGHT ( Approx):** 19.500 KG

Mrp  
**₹ 12,000/-**

## AVAILABLE COLORS:



**BLACK**    **SMOKE GREY**    **SAND PLUTO**

# GARDEN HOSE PIPES

## HI-FLO - ECONOMY GARDENING PIPE

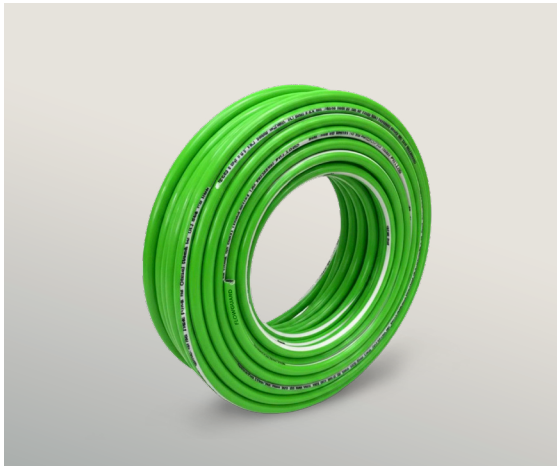

### SIZE & RATE/PC

SIZE	WEIGHT (KG)	PRICE
1/2"	3.5	₹ 1,385/-
3/4"	5.5	₹ 2,175/-
1"	7.5	₹ 2,960/-

## SUPER FOAM - FLEXIBLE PIPE

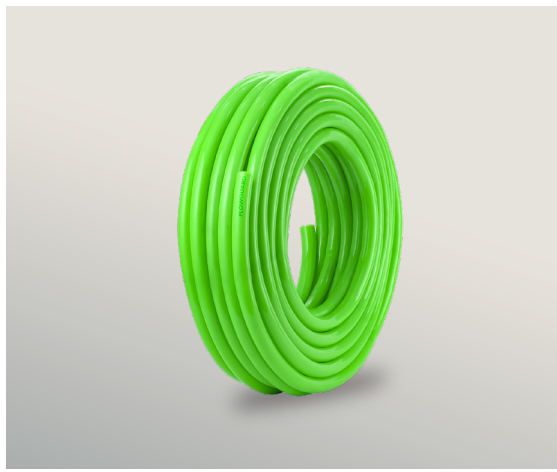

### SIZE & RATE/PC

SIZE	WEIGHT (KG)	PRICE
1/2"	4.0	₹ 1,535/-
3/4"	6.0	₹ 2,300/-
1"	8.0	₹ 3,070/-

## BLACK PEARL - CURING PIPE



### SIZE & RATE/PC

SIZE	WEIGHT (KG)	PRICE
1/2"	4.5	₹ 1,475/-
3/4"	8.5	₹ 2,775/-
1"	10.5	₹ 3,425/-

Image only for reference purpose\*

Dimensions are approximate, not for weights & measurement\*

Transportation extra as applicable\*

**BLACK ZEBRA GLOSSY - ECONOMY CURING PIPE****SIZE & RATE/PC**

SIZE	WEIGHT (KG)	PRICE
1/2"	3.6	₹ 900/-
3/4"	5.6	₹ 1,425/-
1"	7.6	₹ 1,950/-

# ONE PIECE CLOSETS

## FGOPCNC1001-S-9"



Rimless Siphonic Closet  
Vortex Flushing  
L660 W370 H750mm  
S-Trap - 200mm Roughing in

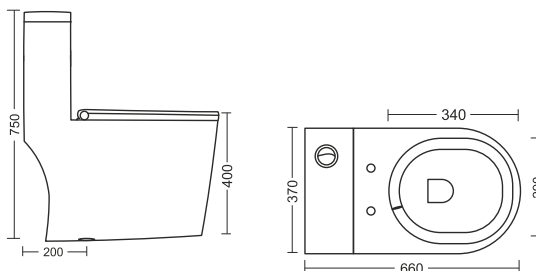

Mrp  
₹ 15,100/-

## FGOPCNC1002-RLWD-9"



Rimless Washdown Closet  
L650 W355 H735mm  
S-Trap - 225mm Roughing in

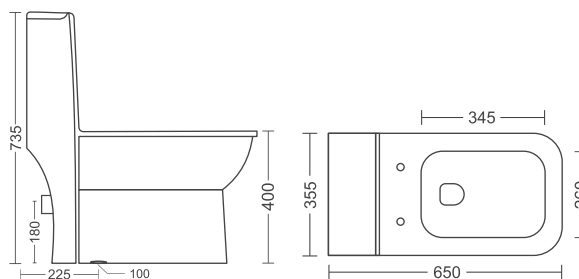

Mrp  
₹ 13,300/-

## FGOPCNC1005-S3D-9"



3D Siphonic Closet  
Tornado Flushing  
L670 W365 H750mm  
S-Trap - 225mm Roughing in

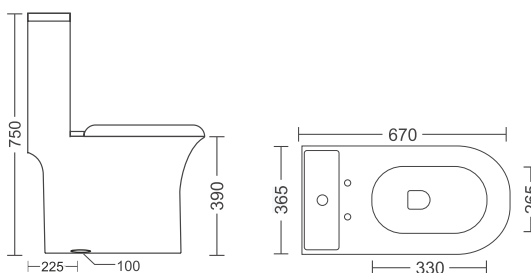

Mrp  
₹ 14,000/-

Image only for reference purpose\*

Dimensions are approximate, not for weights & measurement\*

Transportation extra as applicable\*

## FGOPCNC1006-RLWD-9"



Rimless Washdown Closet  
L650 W370 H750mm  
S-Trap - 225mm Roughing in

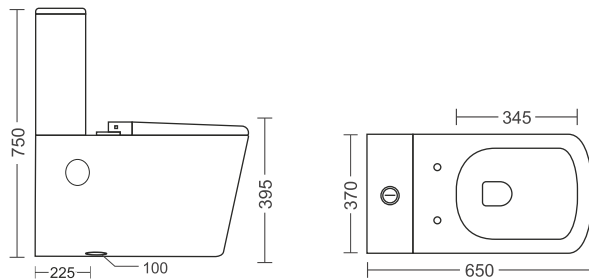

Mrp  
₹ 14,100/-

## FGOPCNC1007-S6D-9"



6D Siphonic Closet  
Tornado Flushing  
L665 W380 H730mm  
S-Trap - 225mm Roughing in

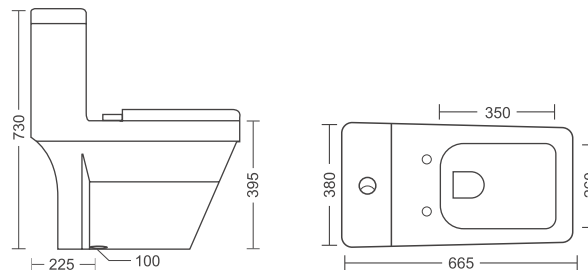

Mrp  
₹ 15,300/-

## FGOPCNC1008-S6D-9"



6D Siphonic Closet  
Tornado Flushing  
L670 W360 H740mm  
S-Trap - 225mm Roughing in

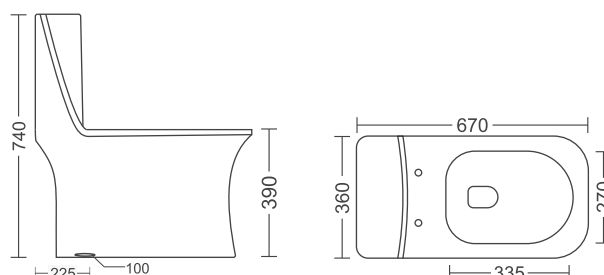

Mrp  
₹ 14,400/-

## FGOPCKC1010-RLWD-9"



Rimless Washdown Closet  
L670 W370 H730mm  
S-Trap - 225mm Roughing In

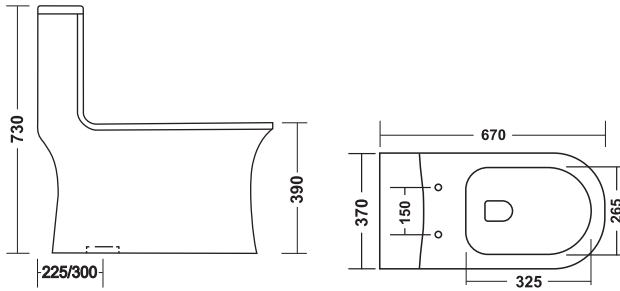

Mrp  
₹ 11,800/-

## FGOPCKC1011-RLWD-9"



Rimless Washdown Closet  
L635 W350 H720mm  
S-Trap - 225mm Roughing In

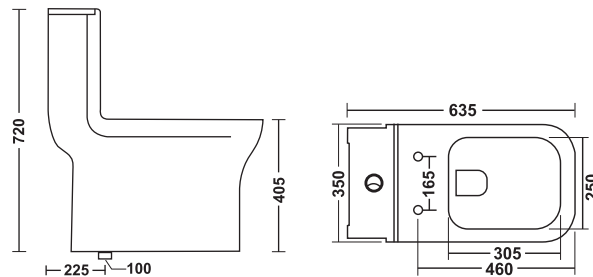

Mrp  
₹ 11,600/-

## FGOPCKC1012P-RLWD



Rimless Washdown Closet  
L670 W370 H730mm  
P-Trap - 180mm

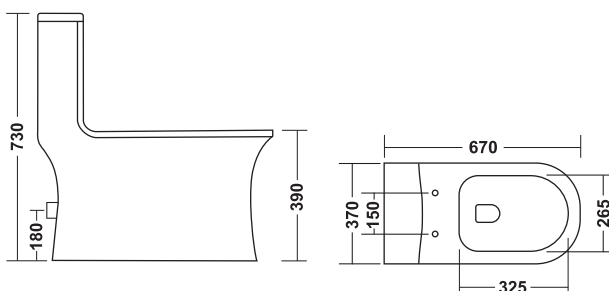

Mrp  
₹ 11,600/-

Image only for reference purpose\*

Dimensions are approximate, not for weights & measurement\*

Transportation extra as applicable\*

## FGOPCNC1013-S3D-9"



3D Siphonic Closet  
Tornado Flushing  
L670 W365 H780mm  
S-Trap - 225mm Roughing In

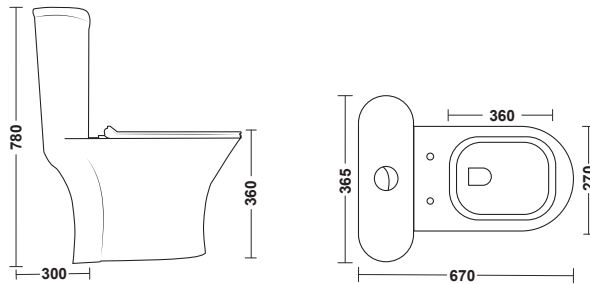

Mrp  
₹ 15,300/-

## FGOPCKC1014-S5D-9"



5D Siphonic Closet  
L645 W355 H740mm  
S-Trap - 225mm Roughing In

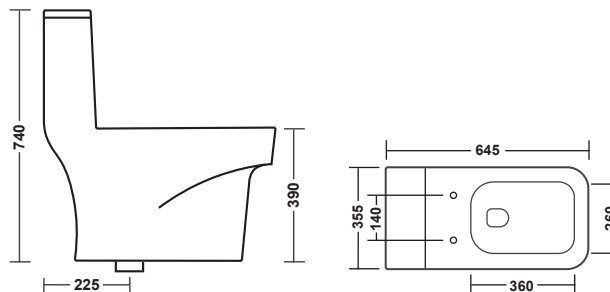

Mrp  
₹ 13,300/-

## FGOPCKC1015-WD-4"



Washdown Closet  
L635 W350 H720mm  
S-Trap - 100mm Roughing In

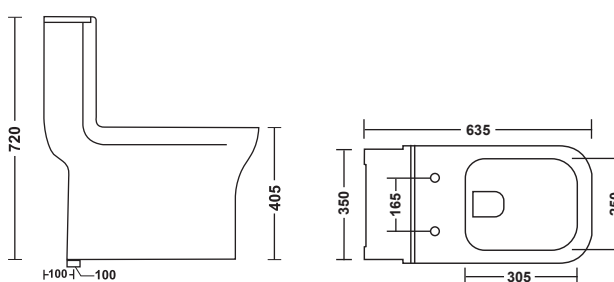

Mrp  
₹ 12,200/-

Image only for reference purpose\*

Dimensions are approximate, not for weights & measurement\*

Transportation extra as applicable\*

## FGOPCKC1016-RLWD-9"



Rimless Washdown Closet  
L700 W365 H765mm  
S-Trap - 225mm Roughing In

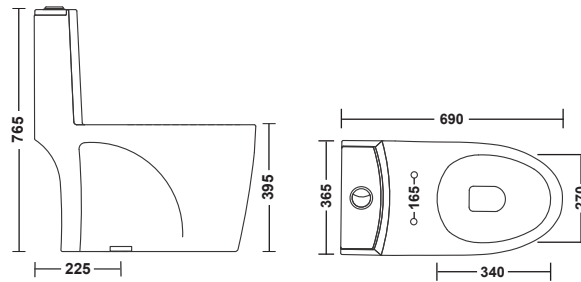

Mrp  
₹ 12,200/-

## FGOPCBR1017-RLWD-9"



Rimless Washdown Closet  
L650 W350 H730mm  
S-Trap - 225mm Roughing In

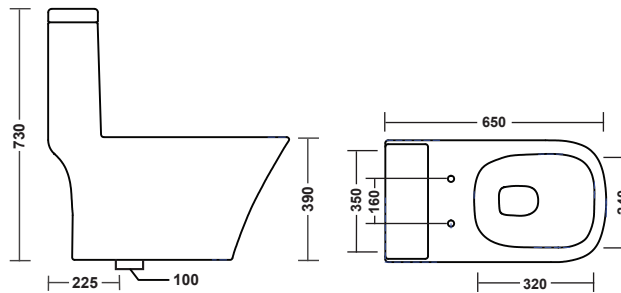

Mrp  
₹ 12,200/-

# WALL HUNG CLOSETS

## FGWHNC2001



Rimless Wall Hung Closet  
L560 W360 H345mm

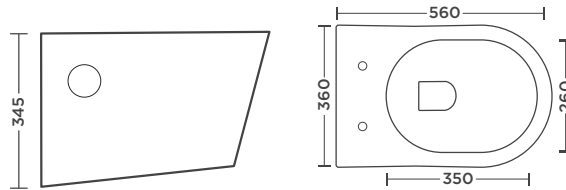

Mrp  
₹ 9,675/-

## FGWHNC2002



Rimless Wall Hung Closet  
L535 W350 H370mm

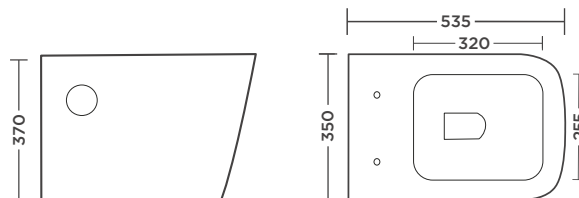

Mrp  
₹ 10,250/-

## FGWHNC2003



Rimless Wall Hung Closet  
L485 W360 H350mm

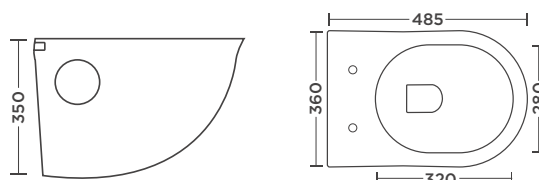

Mrp  
₹ 9,150/-

Image only for reference purpose\*

Dimensions are approximate, not for weights & measurement\*

Transportation extra as applicable\*

# EWC & INDIAN CLOSETS

## FGWCNC3001 - EWC



L550 W370 H400mm  
S-Trap

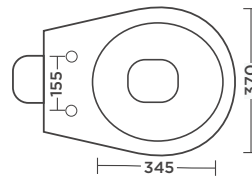
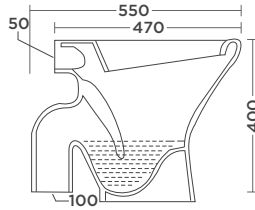

Mrp

A. Commode:  
₹ 3,050/-

B. Seat: (Normal)  
₹ 750/-

C. Flush Tank:  
(Side Handle)  
₹ 1,400/-

## FGOPNC4001 - ORISSA PAN 20"



Squatting Pan  
L510 W420 H240mm

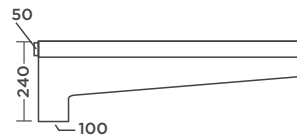
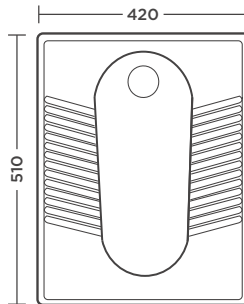

Mrp

₹ 1,950/-

## FGOPNC4002 - CITY PAN 20"



Squatting Pan  
L510 W420 H180mm

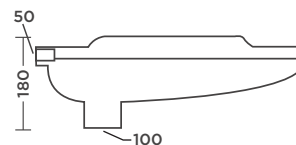
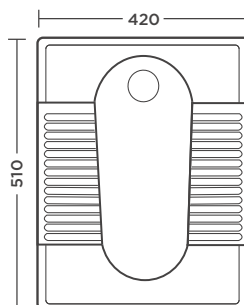

Mrp

₹ 1,950/-

Image only for reference purpose\*

Dimensions are approximate, not for weights & measurement\*

Transportation extra as applicable\*

# PEDESTAL BASINS

## FGPBNC5001



Full Pedestal Basin  
L530 W420 H870mm

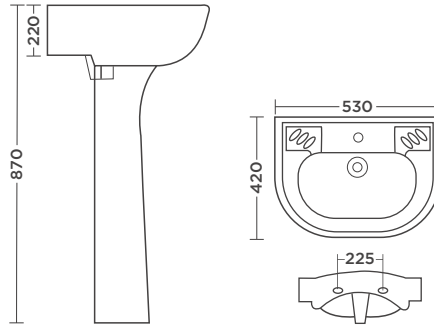

Mrp

A. Basin:  
₹ 2,275/-

B. Pedestal:  
₹ 2,275/-

## FGPBKC5002



Pedestal Basin  
L570 W400 H820mm

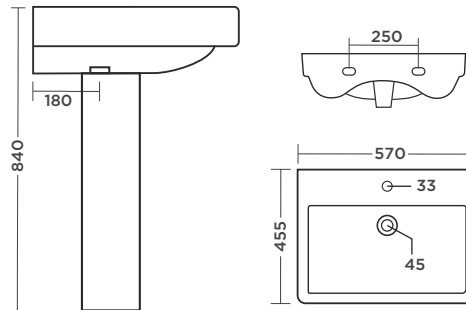

Mrp

A. Basin:  
₹ 2,275/-

B. Pedestal:  
₹ 2,275/-

# TABLE TOP BASINS

## FGTTBNC6001



Table Top Basin  
L460 W345 H130mm

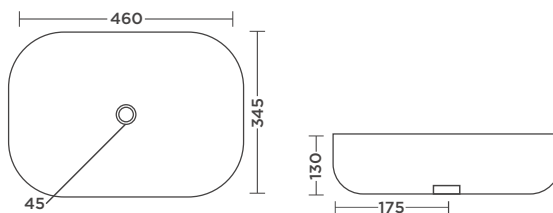

Mrp  
₹ 2,625/-

## FGTTBNC6002



Table Top Basin  
L415 W415 H150mm

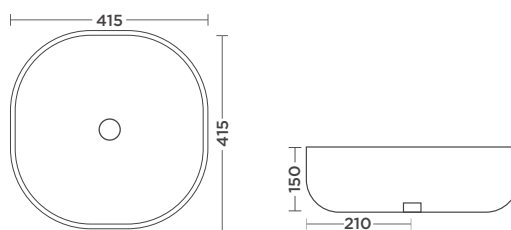

Mrp  
₹ 2,625/-

## FGTTBNC6003



Table Top Basin  
L510 W380 H140mm

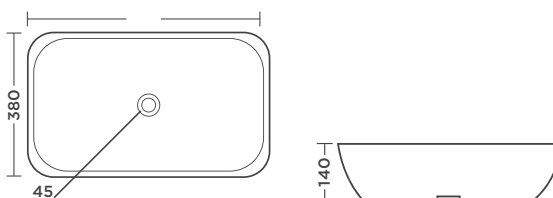

Mrp  
₹ 3,150/-

Image only for reference purpose\*

Dimensions are approximate, not for weights & measurement\*

Transportation extra as applicable\*

**FGTTBNC6004**



Table Top Basin  
L420 W350 H190mm

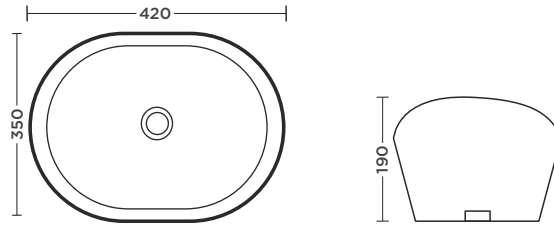

Mrp  
₹ 2,575/-

**FG2IN1NC6005**



Table Top 2 in 1 Basin  
L420 W315 H125mm

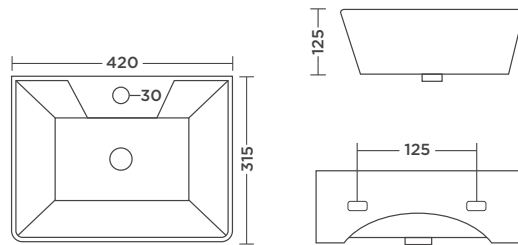

Mrp  
₹ 2,400/-

**FG2IN1NC6006**



Table Top 2 in 1 Basin  
L330 W305 H120mm

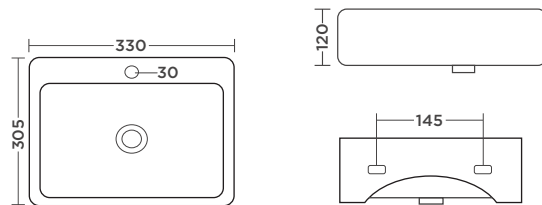

Mrp  
₹ 2,600/-

Image only for reference purpose\*

Dimensions are approximate, not for weights & measurement\*

Transportation extra as applicable\*

# FG2IN1NC6007



Table Top 2 in 1 Basin  
L360 W360 H100mm

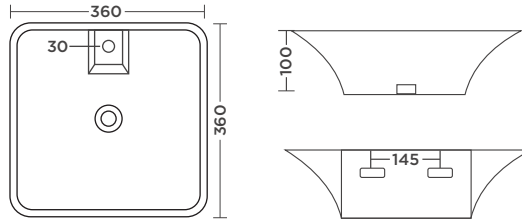

Mrp  
₹ 2,700/-

# FG2IN1NC6008



Table Top 2 in 1 Basin  
L350 W490 H120mm

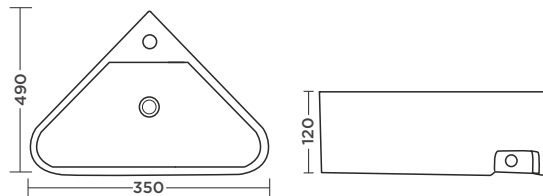

Mrp  
₹ 3,050/-

# FGTTBNC6009



Table Top Basin  
L485 W385 H120mm

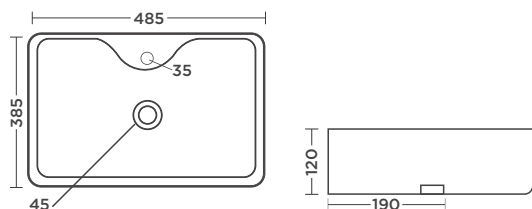

Mrp  
₹ 2,475/-

Image only for reference purpose\*

Dimensions are approximate, not for weights & measurement\*

Transportation extra as applicable\*

## FGTTBNC6010



Table Top Basin  
L540 W390 H145mm

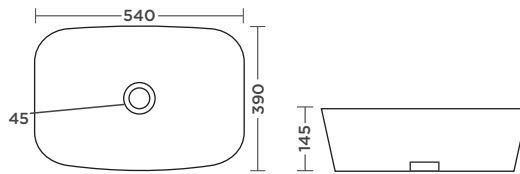

Mrp  
₹ 3,100/-

## FGTTBNC6011



Table Top Basin  
L400 W400 H155mm

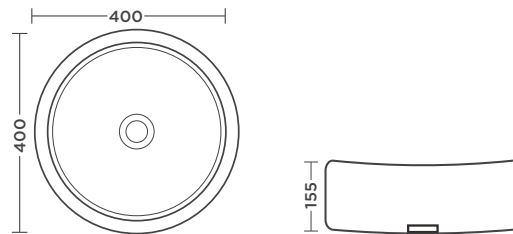

Mrp  
₹ 3,125/-

## FGTTBNC6012



Table Top Basin  
L505 W395 H135mm

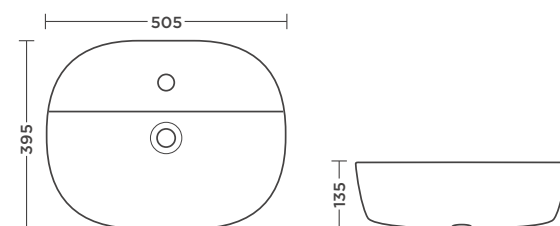

Mrp  
₹ 3,125/-

# FGTTBNC6013



Table Top Basin  
L700 W360 H135mm

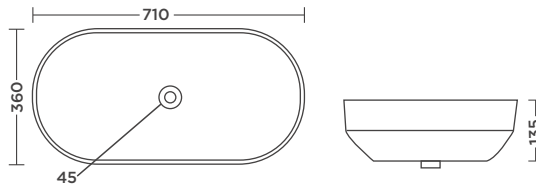

Mrp  
₹ 4,275/-

# FGTTBNC6014



Table Top Basin  
L600 W415 H175mm

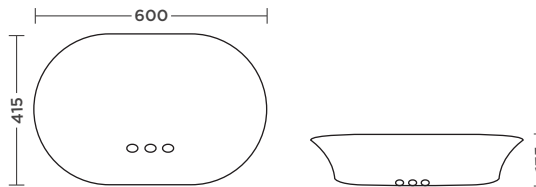

Mrp  
₹ 8,675/-

# INTEGRATED WALL HUNG BASINS

## FGIWBNC7001



Integrated Wall Hung Basin  
L505 W445 H390mm

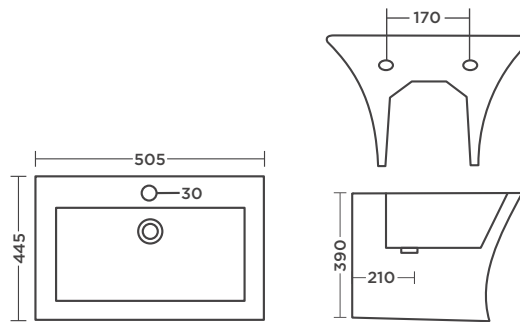

Mrp  
₹ 5,825/-

## FGIWBNC7002



Integrated Wall Hung Basin  
L340 W370 H255mm

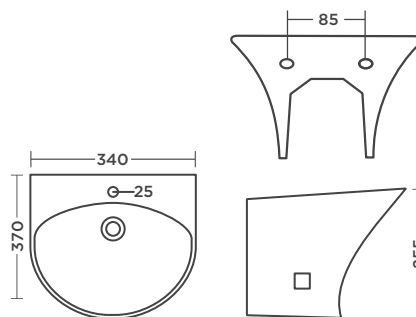

Mrp  
₹ 3,350/-

# WALL HUNG BASINS

## FGWHBNC8001



Wall Hung Basin  
L455 W360 H160mm

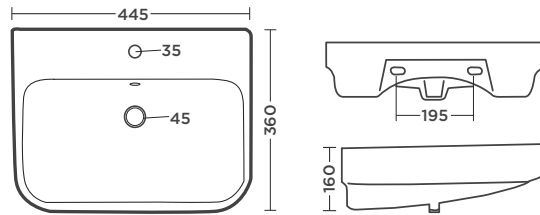

Mrp  
₹ 1,875/-

## FGWHBNC8002



Wall Hung Basin  
L450 W330 H165mm

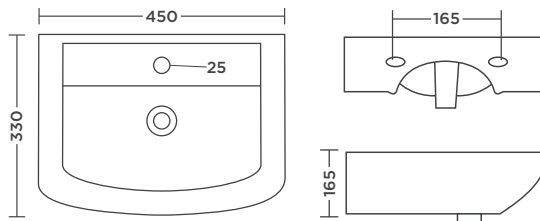

Mrp  
₹ 1,825/-

## FGWHBNC8003



Wall Hung Basin  
L335 W335 H130mm

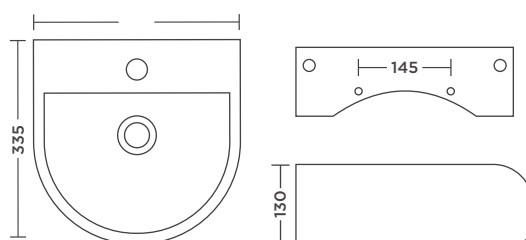

Mrp  
₹ 1,800/-

Image only for reference purpose\*

Dimensions are approximate, not for weights & measurement\*

Transportation extra as applicable\*

## FGWHBNC8004



Wall Hung Basin  
L435 W325 H130mm

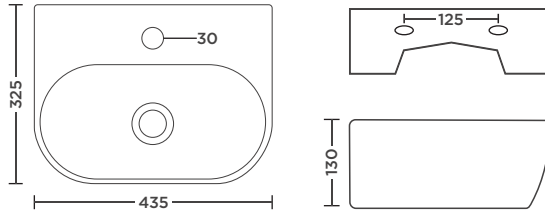

Mrp  
₹ 2,600/-

## FGWHBNC8005



Wall Hung Vanity Basin  
L600 W445 H170mm

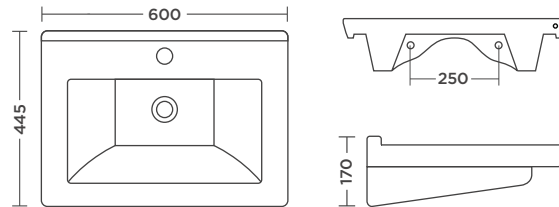

Mrp  
₹ 3,975/-

## FGWHBNC8006



Wall Hung Basin  
L425 W345 H140mm

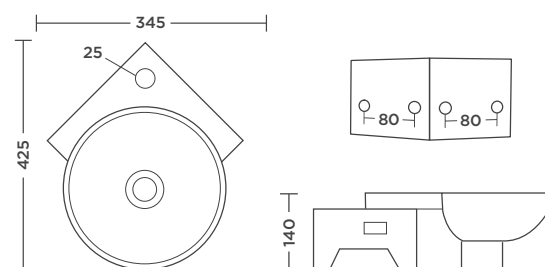

Mrp  
₹ 1,750/-

## FGWHBNC8007



Wall Hung Basin  
L405 W320 H140mm

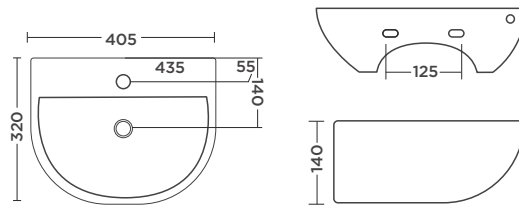

Mrp  
₹ 1,950/-

## FGWHBNC8008



Wall Hung Basin  
L460 W260 H110mm

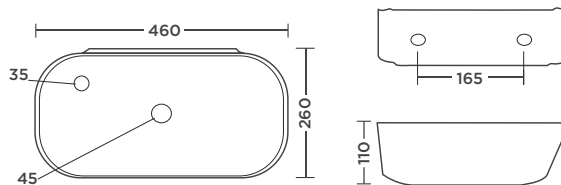

Mrp  
₹ 2,300/-

## FGWHBNC8009



Wall Hung Basin  
L365 W350 H160mm

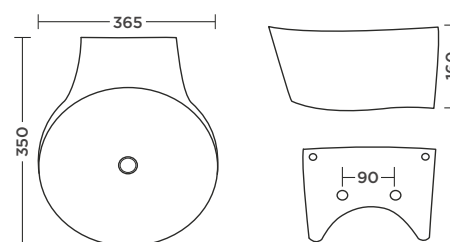

Mrp  
₹ 2,300/-

# FGWHBNC8010



Wall Hung Basin  
L475 W365 H175mm

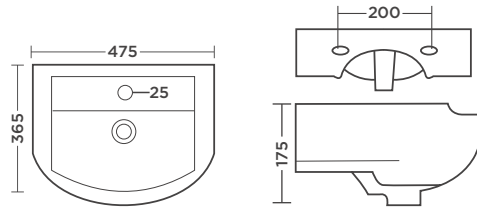

Mrp  
₹ 1,825/-

# FGWHBNC8011



Wall Hung Basin  
L460 W345 H175mm

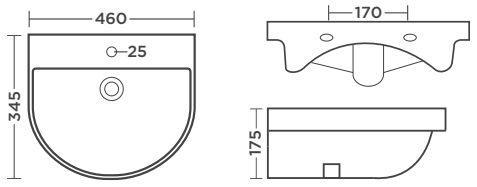

Mrp  
₹ 1,825/-

# FGWHBNC8012



Wall Hung Basin  
L465 W335 H175mm

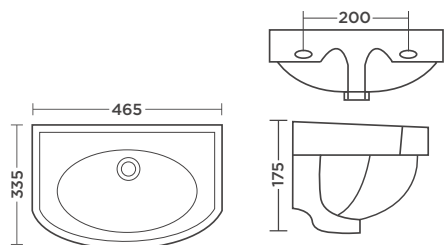

Mrp  
₹ 1,825/-

Image only for reference purpose\*

Dimensions are approximate, not for weights & measurement\*

Transportation extra as applicable\*

# FGWHBNC8013



Wall Hung Basin  
L405 W320 H125mm

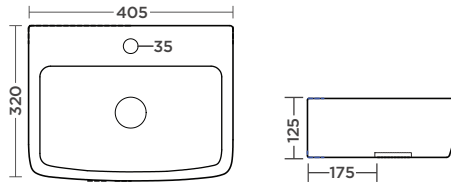

Mrp  
₹ 1,950/-

# ONE PIECE BASINS

## FGOPBNC9001



One Piece Basin  
L410 W380 H810mm

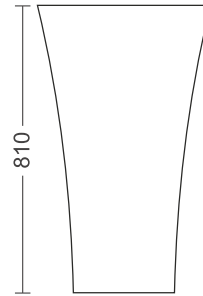
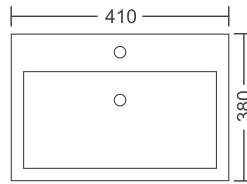

Mrp  
₹ 11,000/-

## FGOPBNC9002



One Piece Basin  
L405 W405 H845mm

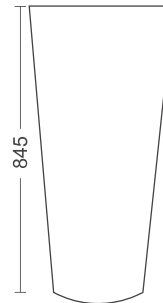
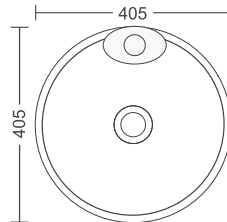

Mrp  
₹ 8,550/-

# HEALTH FAUCETS

## PREMIUM WHITE



With Tube (1 Mtr)  
Mrp ₹ **575/-**

Without Tube  
Mrp ₹ **350/-**

## ROYAL WHITE



With Tube (1 Mtr)  
Mrp ₹ **575/-**

Without Tube  
Mrp ₹ **350/-**

## SUPREME CP



With Tube (1 Mtr)  
Mrp ₹ **975/-**

Without Tube  
Mrp ₹ **545/-**

## SUPREME WHITE



With Tube (1 Mtr)  
Mrp ₹ **675/-**

Without Tube  
Mrp ₹ **475/-**

## STYLE CP



With Tube (1 Mtr)  
Mrp ₹ **1,575/-**

Without Tube  
Mrp ₹ **1,050/-**

## PRIME CP



With Tube (1 Mtr)  
Mrp ₹ **1,095/-**

Without Tube  
Mrp ₹ **575/-**

## ELITE CP



With Tube (1 Mtr)  
Mrp ₹ **975/-**

## ELITE BLACK



With Tube (1 Mtr)  
Mrp ₹ **725/-**

## CHARCOAL SERIES

**FG23101**  
BIB COCK



Mrp  
₹ 210/-

**FG23102**  
PILLAR COCK



Mrp  
₹ 300/-

**FG23102FF**  
PILLAR COCK [Tall]



Mrp  
₹ 375/-

**FG23103**  
ANGLE COCK



Mrp  
₹ 195/-

**FG23104**  
LONG BODY



Mrp  
₹ 245/-

**FG23105**  
2 IN 1 BIB COCK



Mrp  
₹ 390/-

**FG23106**  
SINK COCK



Mrp  
₹ 345/-

**FG23108**  
SINK COCK [Long Spout]



Mrp  
₹ 450/-

**FG23109**  
SWAN NECK [Long Spout]



Mrp  
₹ 500/-

**FG23110-W**  
WASHING MACHINE BIB  
COCK [2 Adjustments]



Mrp  
₹ 340/-

**FG23111**  
NOZZLE TAP



Mrp  
₹ 310/-

**FG23112**  
2 WAY ANGLE COCK



Mrp  
₹ 390/-

### FG23115

WALL MIXER WITH  
L BEND



Mrp  
₹ 1,975/-

### FG23119RF

BIB COCK RAIN/  
FOAM FLOW



Mrp  
₹ 330/-

### FG23120RF

LONG BODY RAIN/  
FOAM FLOW



Mrp  
₹ 355/-

# ECO SERIES

**FG12101-WB**  
BIB COCK - 90



Mrp  
₹ 165/-

**FG12102ff-WB**  
PILLAR COCK [Tall]



Mrp  
₹ 350/-

**FG12103-WB**  
ANGLE COCK - 90



Mrp  
₹ 165/-

**FG12104-WB**  
LONG BODY - 90



Mrp  
₹ 185/-

**FG12105-WB**  
2 IN 1 BIB COCK



Mrp  
₹ 355/-

**FG12108**  
SINK COCK [Long Spout]



Mrp  
₹ 435/-

### FG12109

SWAN NECK [Long Spout]



Mrp  
₹ 465/-

### FG12110W

WASHING MACHINE BIB  
COCK [2 Adjustments]



Mrp  
₹ 275/-

### FG12111

NOZZLE TAP



Mrp  
₹ 210/-

### FG12112-WB

2 WAY ANGLE COCK



Mrp  
₹ 355/-

# PRIME SERIES

**FG40101-WB**  
BIB COCK-90

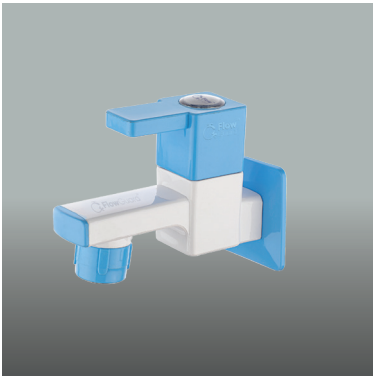

Mrp  
₹ 350/-

**FG40104-WB**  
LONG BODY-90

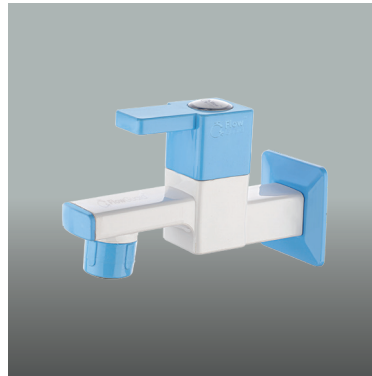

Mrp  
₹ 425/-

# CLASSIC SERIES

**FG25101-WH**  
BIB COCK-90



Mrp  
₹ 210/-

**FG25104-WH**  
LONG BODY-90



Mrp  
₹ 250/-

# FLOOR DRAINERS

## HT-1001 - SQUARE FLOOR DRAINER



Size: 127MM x 127MM (5"X5")

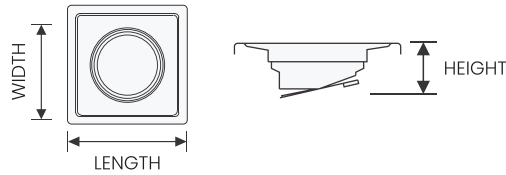

Mrp  
₹ 440/-

### OPTIONAL:

WITH ANTI-COCKROACH  
(with additional cost)



## HT-1002 - SQUARE FLOOR DRAINER



Size: 127MM x 127MM (5"X5")

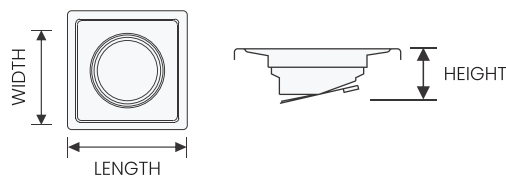

Mrp  
₹ 440/-

### OPTIONAL:

WITH ANTI-COCKROACH  
(with additional cost)



WITH HOLE



## HT-1006 - SQUARE FLOOR DRAINER

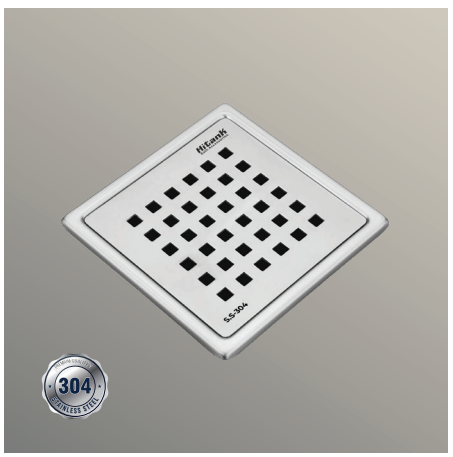

Size: 127MM x 127MM (5"X5")

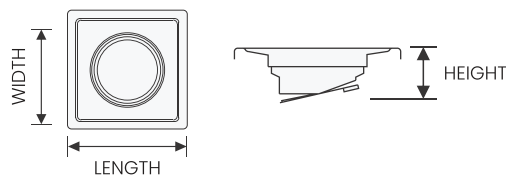

Mrp  
₹ 440/-

### OPTIONAL:

WITH ANTI-COCKROACH  
(with additional cost)



## HT-1115 - ANTI COCKROACH BOWL

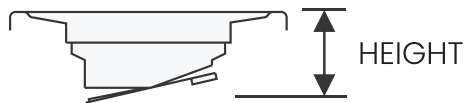

Mrp  
₹ 425/-

## HT-2101 - TILE INSERT FLOOR DRAINER

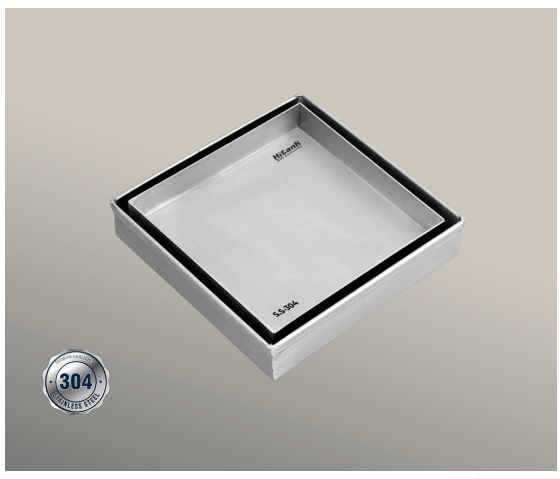

L127mm W127mm  
H40mm Dia 94mm

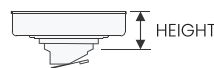
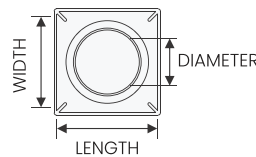

### FEATURES:



Mrp  
₹ 1,215/-

## HT-4101 - SHOWER CHANNEL DRAINER

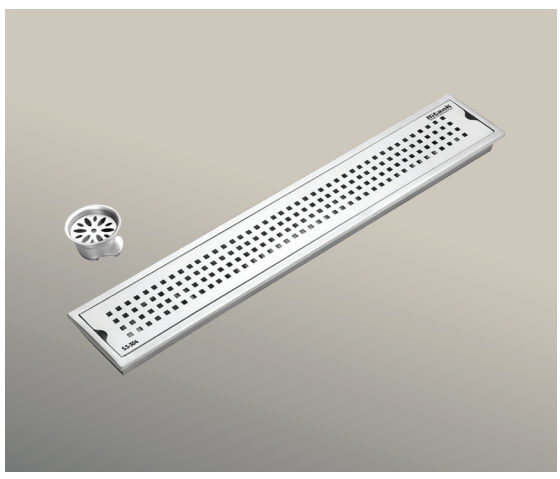

DIMENSION IN MM				
LENGTH	WIDTH	OUTLET DIA.	HEIGHT	RATE/PC
300 (12")	100	60	32	₹2,200/-
450 (18")	100	60	32	₹3,275/-
600 (24")	100	60	32	₹4,100/-

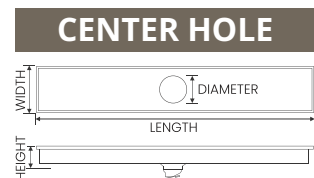
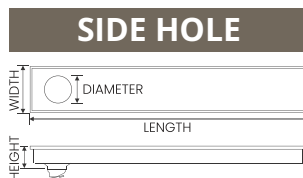

Image only for reference purpose\*

Dimensions are approximate, not for weights & measurement\*

Transportation extra as applicable\*

## HT-4102 - SHOWER CHANNEL DRAINER



DIMENSION IN MM				
LENGTH	WIDTH	OUTLET DIA.	HEIGHT	RATE/PC
300 (12")	100	60	32	₹2,200/-
450 (18")	100	60	32	₹3,275/-
600 (24")	100	60	32	₹4,100/-

### SIDE HOLE

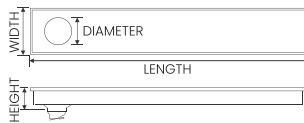

### CENTER HOLE

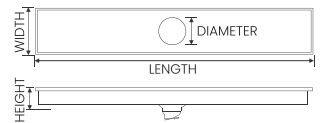

## HT-4103 - SHOWER CHANNEL DRAINER

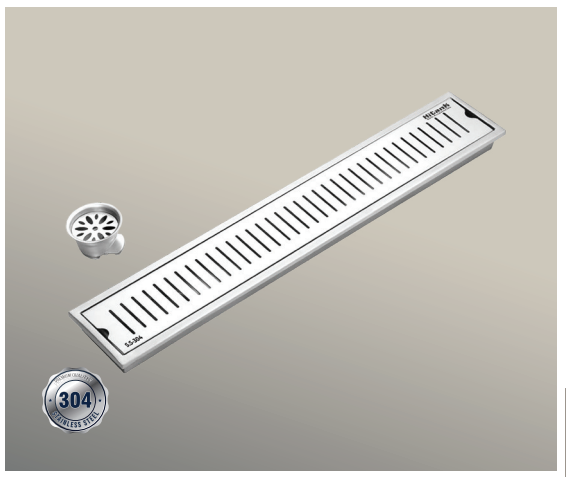

DIMENSION IN MM				
LENGTH	WIDTH	OUTLET DIA.	HEIGHT	RATE/PC
300 (12")	100	60	32	₹2,200/-
450 (18")	100	60	32	₹3,275/-
600 (24")	100	60	32	₹4,100/-

### SIDE HOLE

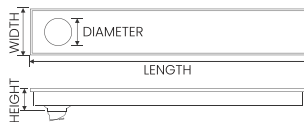

### CENTER HOLE

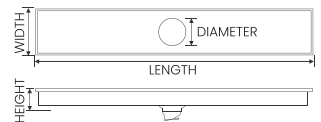

## HT-4104 - TILE INSERT CHANNEL DRAINER

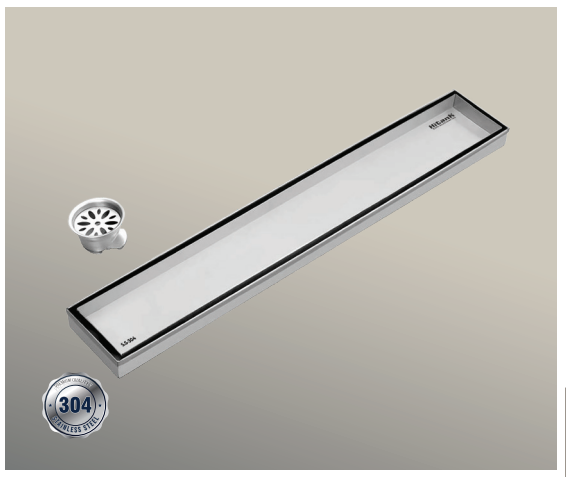

DIMENSION IN MM				
LENGTH	WIDTH	OUTLET DIA.	HEIGHT	RATE/PC
300 (12")	100	60	32	₹2,200/-
450 (18")	100	60	32	₹3,275/-
600 (24")	100	60	32	₹4,100/-
900 (36")	100	60	32	₹6,350/-

### SIDE HOLE

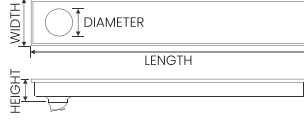

### CENTER HOLE

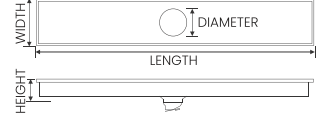

Image only for reference purpose\*

Dimensions are approximate, not for weights & measurement\*

Transportation extra as applicable\*

# BATH ACCESSORIES

## BASIN RACK BOLT

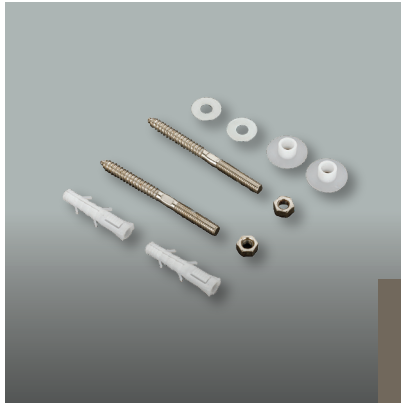

Size: 3/8

Mrp  
₹ 80/-

## BASIN COUPLING



3.25"  
Mrp  
₹ 425/-

5"  
Mrp  
₹ 620/-

## SINK COUPLING ROUND - 0001



Mrp  
₹ 325/-

## SINK COUPLING SQUARE - 0002



Mrp  
₹ 375/-

## MAGIC WASTE PIPE



Mrp  
₹ 100/-

## POLYAMIDE CONNECTION PIPE



18"  
Mrp  
₹ 210/-

24"  
Mrp  
₹ 230/-

## PULL OUT SHOWER TUBE



1 Mtr  
Mrp  
₹ 500/-

## OUR PRODUCT RANGE

- Overhead Water Tanks - Outdoor Usage
- Containers & Industrial Products - Indoor Usage
- Dustbins
- FRP Chamber Covers
- Kitchen Quartz Sinks
- Garden Hose Pipes
- Bathwares
- Health Faucets
- Taps & Fittings
- Floor Drainers
- Bath Accessories

**OSWAL** HI-TECH PVT. LTD.

11/14, Peddanapalya Village, Thavarekere Hobli, Magadi Road,  
Bangalore South Taluk, Bengaluru - 562130, Karnataka, India.

+91 80 5027 3595 | +91 80 5027 3596

sales@hitank.in



SCAN QR CODE TO VIEW  
OUR WEBSITE [hitank.in](https://hitank.in)

## SCAN QR CODE TO FOLLOW US:

